

THE HEIDI CHRONICLES US SCREEN

PRODUCED BY: OTTERBEIN UNIVERSITY

DIRECTOR: ELENI PAPALEONARDOS

DESIGNER: GABI AHUMADA MIER Y CONCHA

TECHNICAL DIRECTOR: SOPHIE RODRIGUEZ

PLATE #

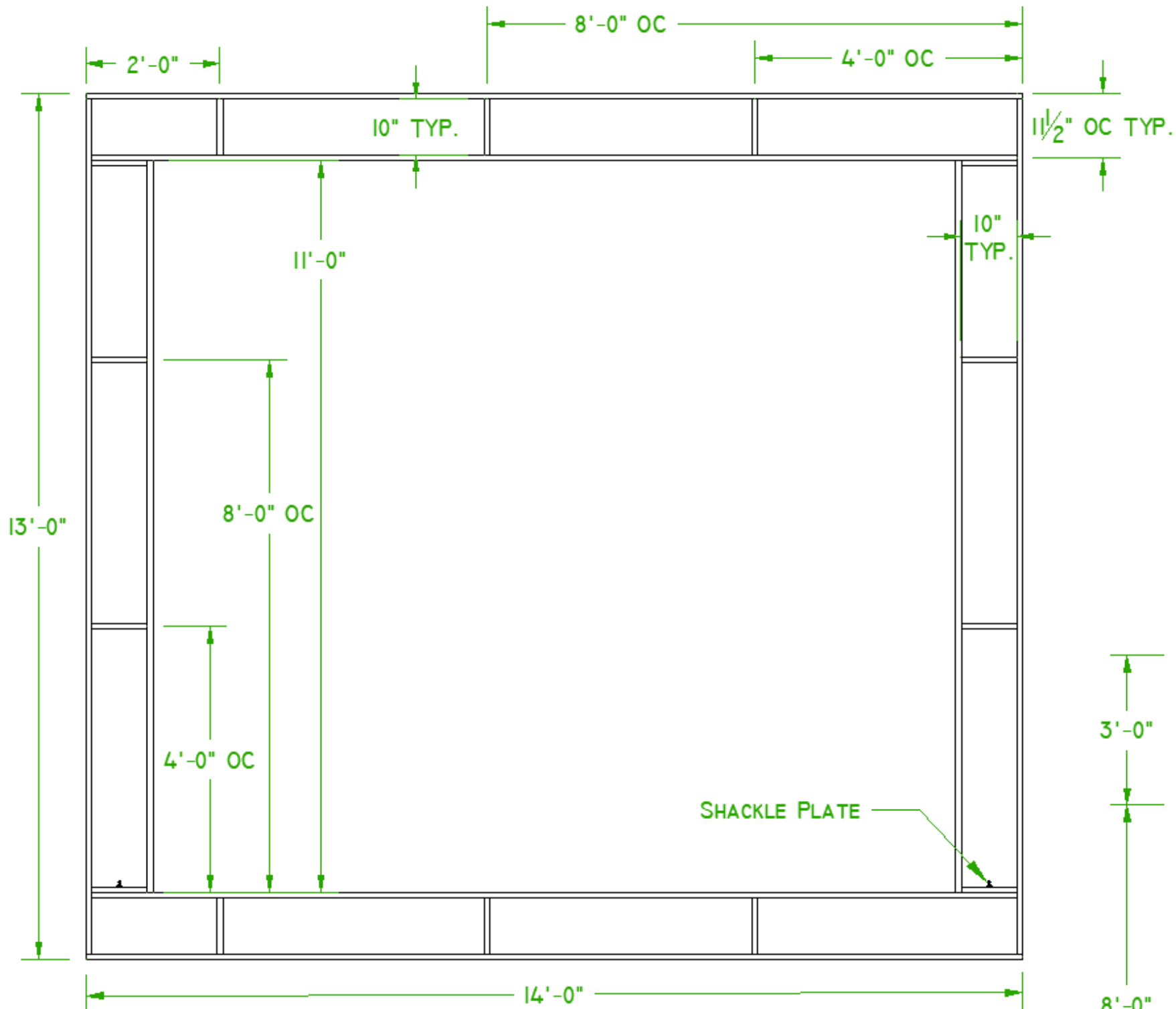

US SCREEN FRAME & HARDWARE TOP

- MADE FROM 1"X1" BOX TUBE STEEL 1/2"=1'
- GRIND ONE SIDE FLAT
- ATTACH RIGGING HARDWARE AND DRILL HOLES BEFORE ATTACHING LAUAN
- SHACKLE PLATES PLACED OC OF 10" PIECE
- SEE TD FOR FURRING STRIP INSTRUCTIONS

US SCREEN LAUAN LAYOUT TOP

- ATTACH RIGGING HARDWARE & DRILL HOLES BEFORE ATTACHING LAUAN 3/8"=1'
- USE LIQUID NAIL BEFORE ATTACHING LAUAN
- SCREW THROUGH LAUAN INTO METAL FRAME

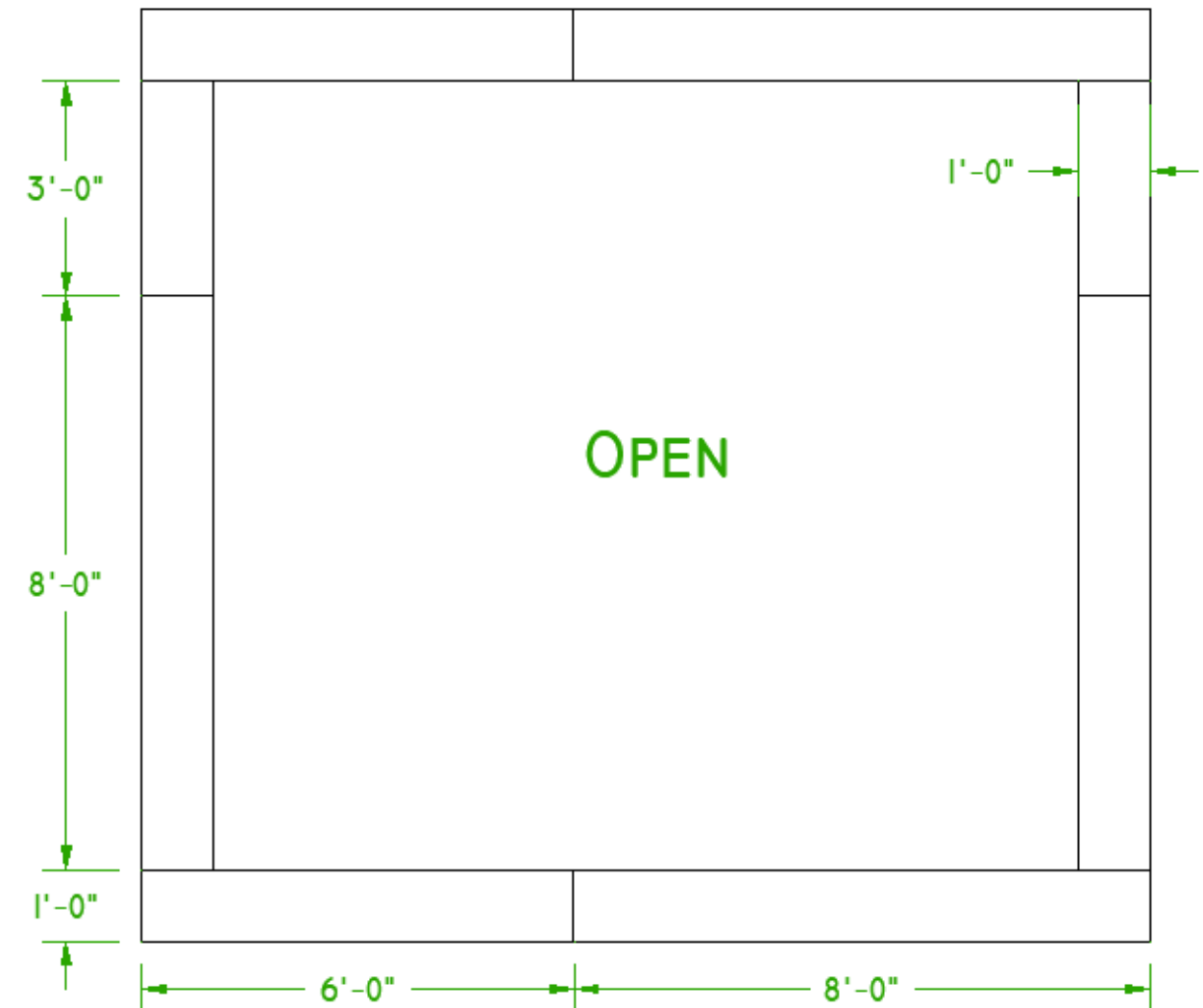

THE HEIDI CHRONICLES
SL PLAT. A RAILING

PRODUCED BY: OTTERBEIN UNIVERSITY
DIRECTOR: ELENI PAPALEONARDOS
DESIGNER: GABI AHUMADA MIER Y CONCHA
TECHNICAL DIRECTOR: SOPHIE RODRIGUEZ

PLATE #
4
OF 32

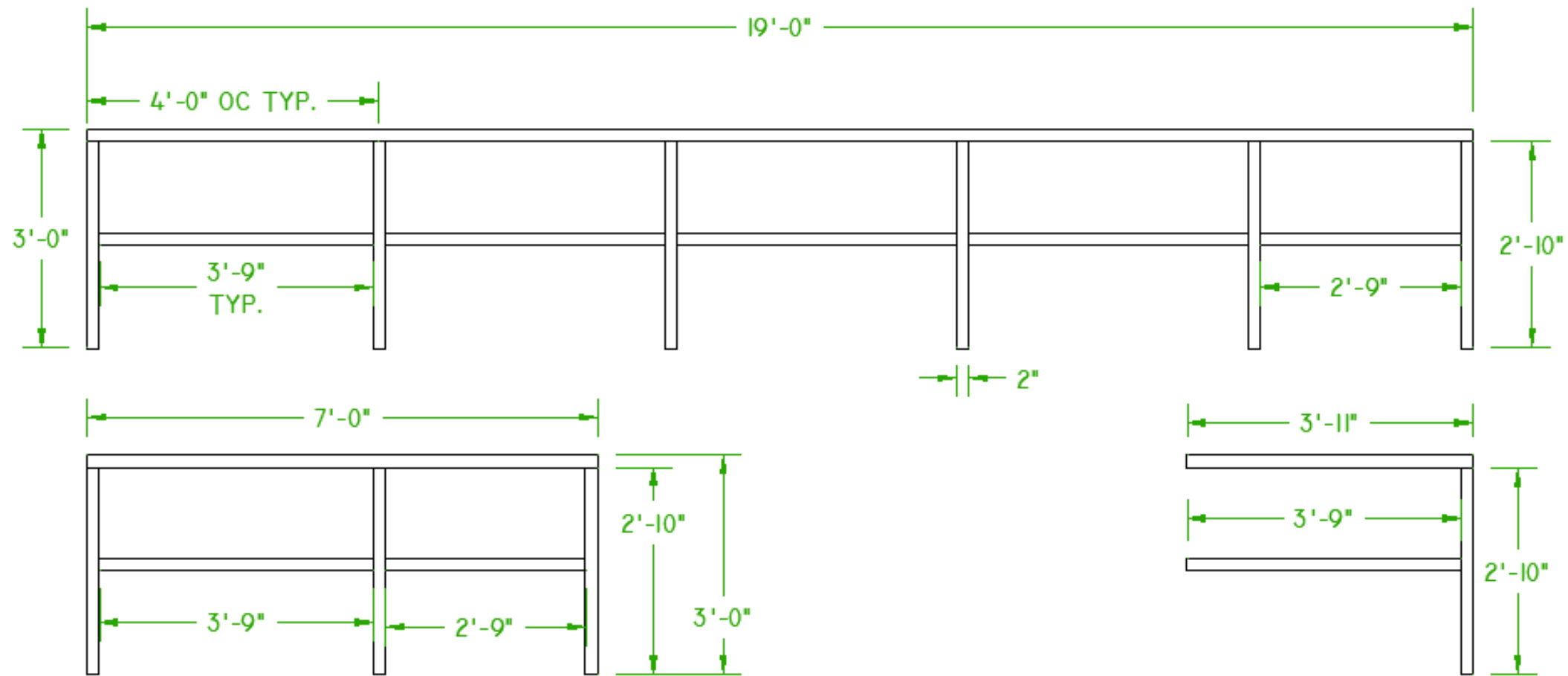

SL PLATFORM A RAILING

- BUILD FROM 1"x2" BOX TUBE STEEL
- AFTER WELDING, GRIND BOTH SIDES
- ADD ANGLE IRON TABS WITH HOLES DRILLED, SEE TD
- LABEL EACH COMPLETED PIECE WITH PLATE NAME

FRONT
1/2"=1'

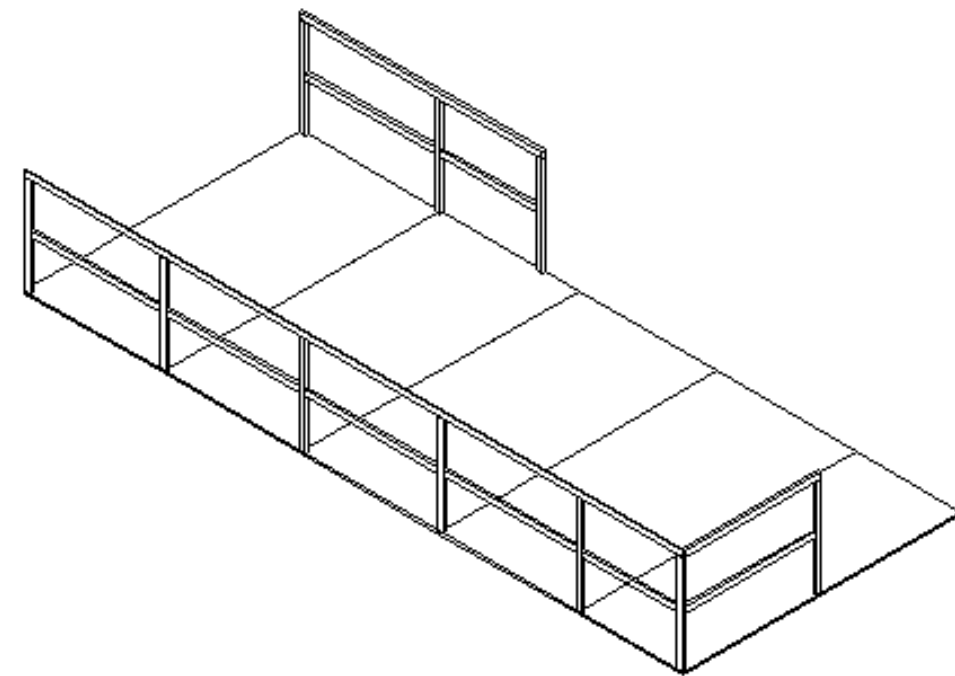

SL PLATFORM A RAILING LOAD IN

FRONT ISO
1/4"=1'

THE HEIDI CHRONICLES SL PLATFORM B COMPOSITE

PRODUCED BY: OTTERBEIN UNIVERSITY

DIRECTOR: ELENI PAPALEONARDOS

DESIGNER: GABI AHUMADA MIER Y CONCHA

TECHNICAL DIRECTOR: SOPHIE RODRIGUEZ

PLATE #

7

OF 32

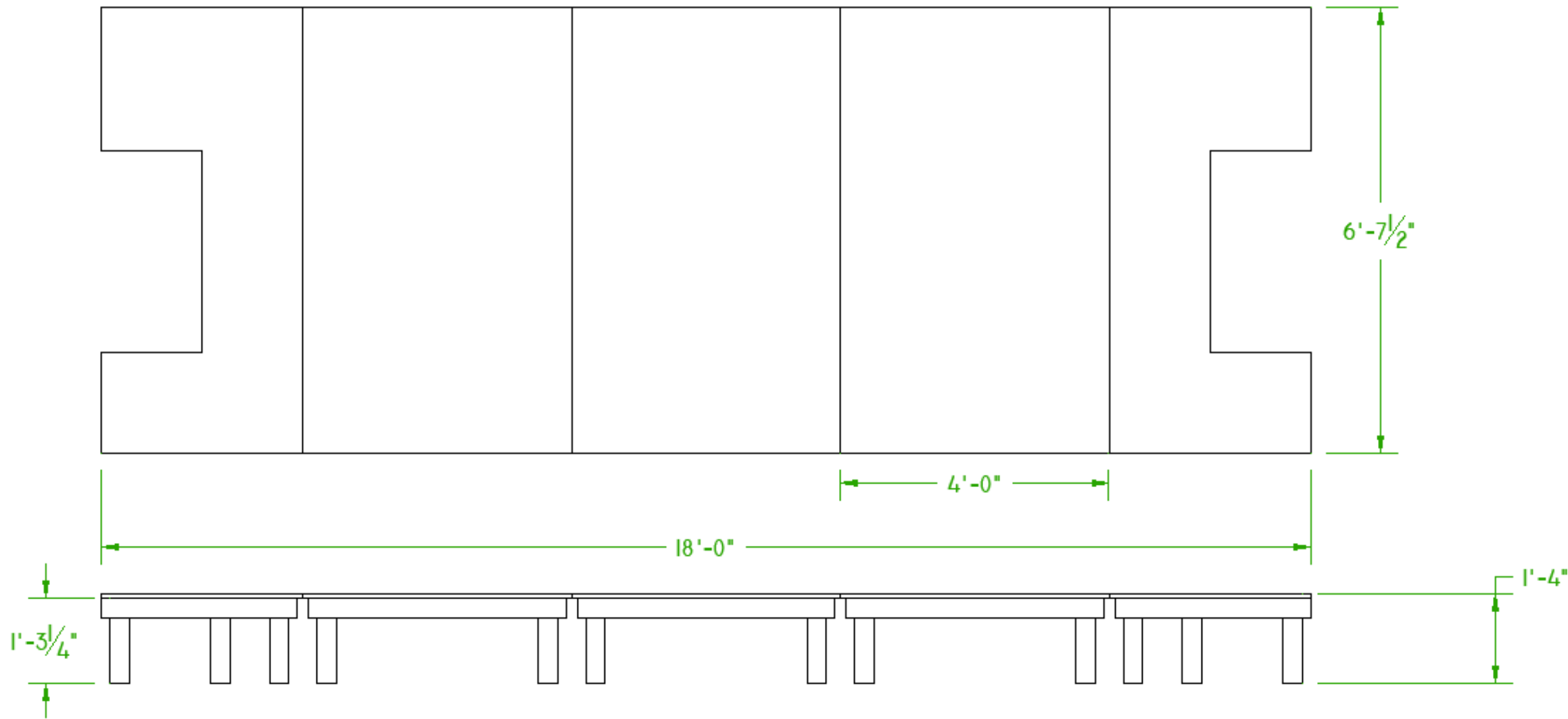

SL PLATFORM B COMPOSITE

TOP, FRONT

1/2"=1'

- USE PLATFORMS FROM PLATES NO.5 AND NO.6
- LEGS ARE 1'3-1/4" - USE STOCK LEGS, SEE TD
- PLACE LEGS AS NEEDED BEFORE CONNECTING PLATFORMS
- GUSSET PLATFORMS TOGETHER USING RIPPED PLYWOOD

SL PLATFORM B COMPOSITE

FRONT ISO

3/8"=1'

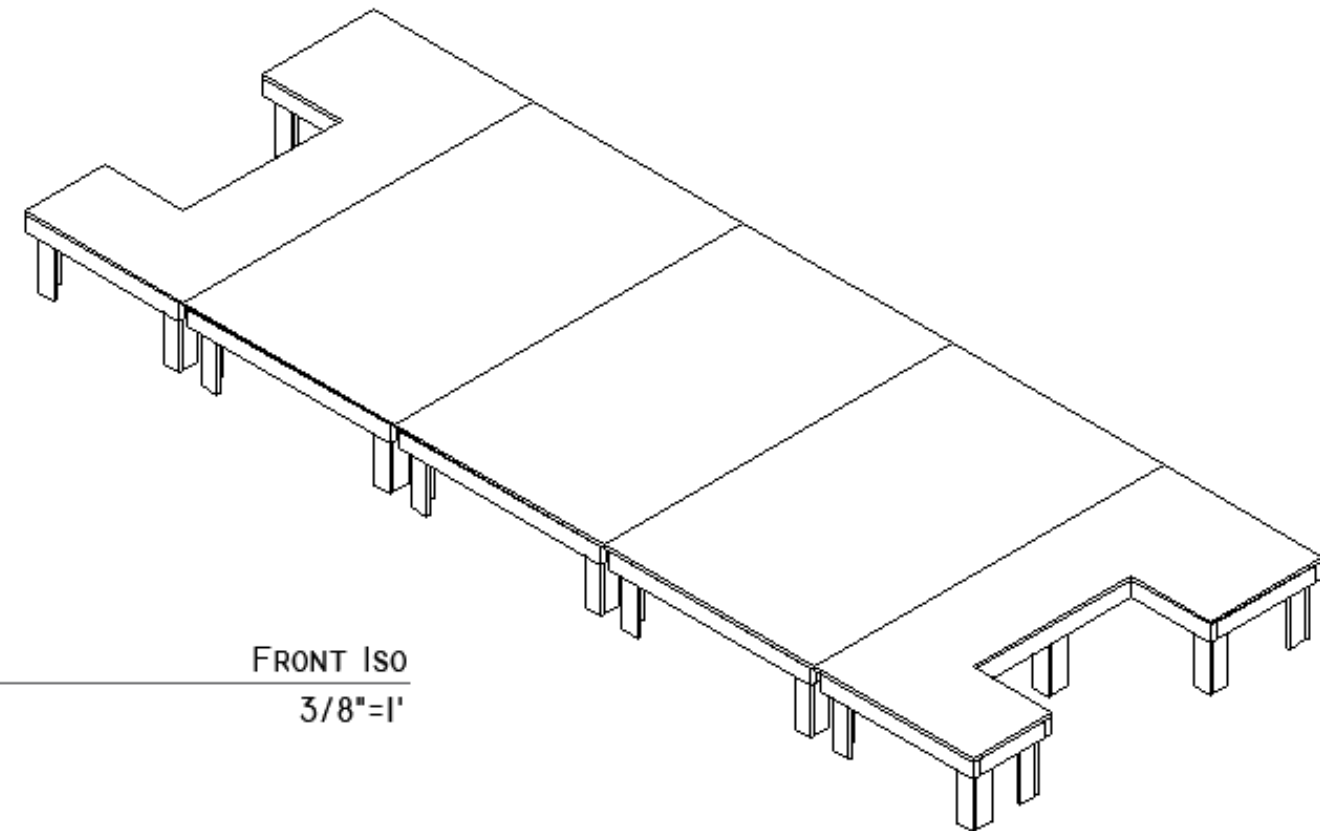

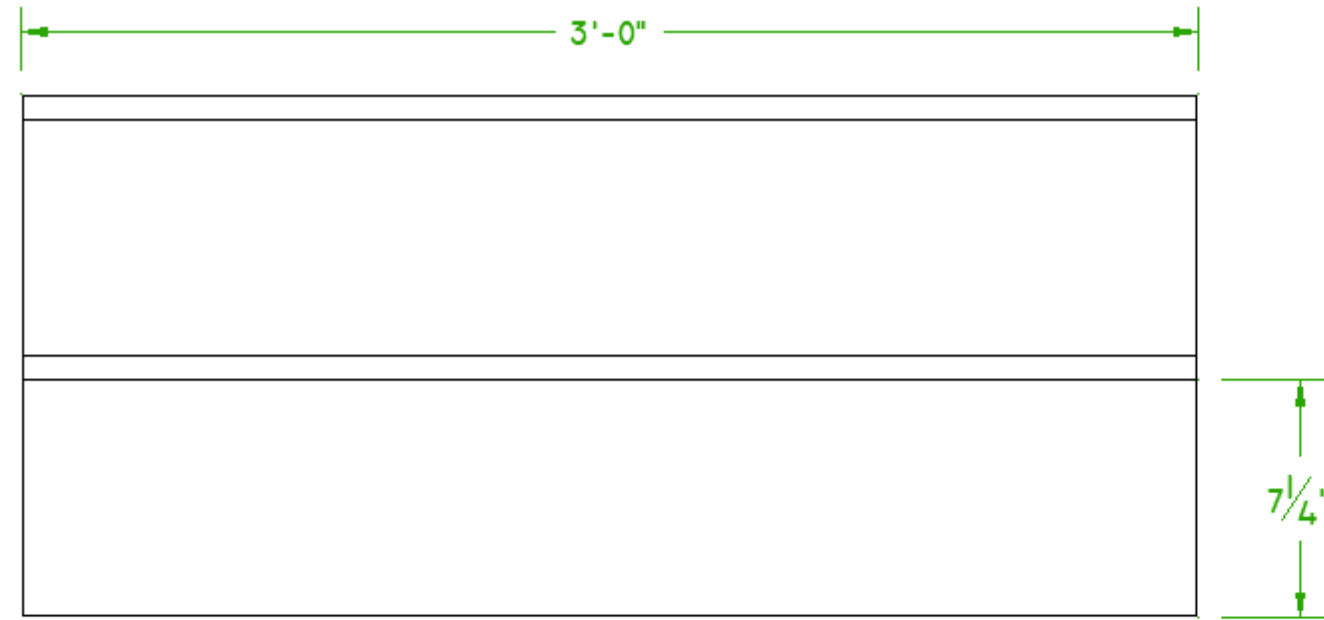
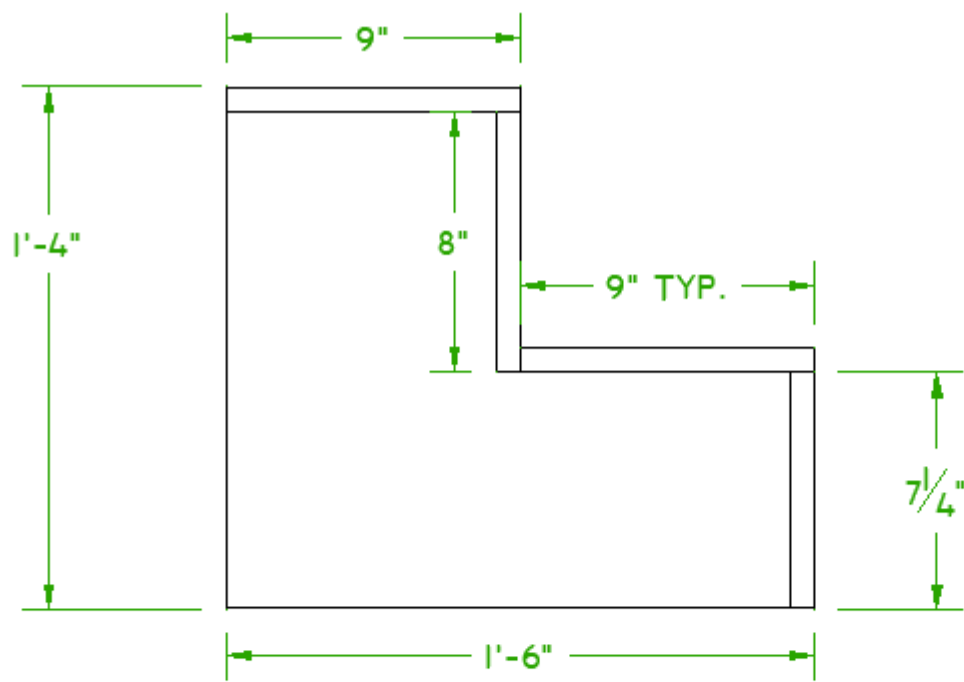

SL PLATFORM B STAIRS COMPOSITE

SIDE, FRONT

- BUILD TWO
- BUILD ENTIRELY FROM PLYWOOD
- USE WOOD GLUE, SLANT NAILS, AND SCREWS

2"=1'

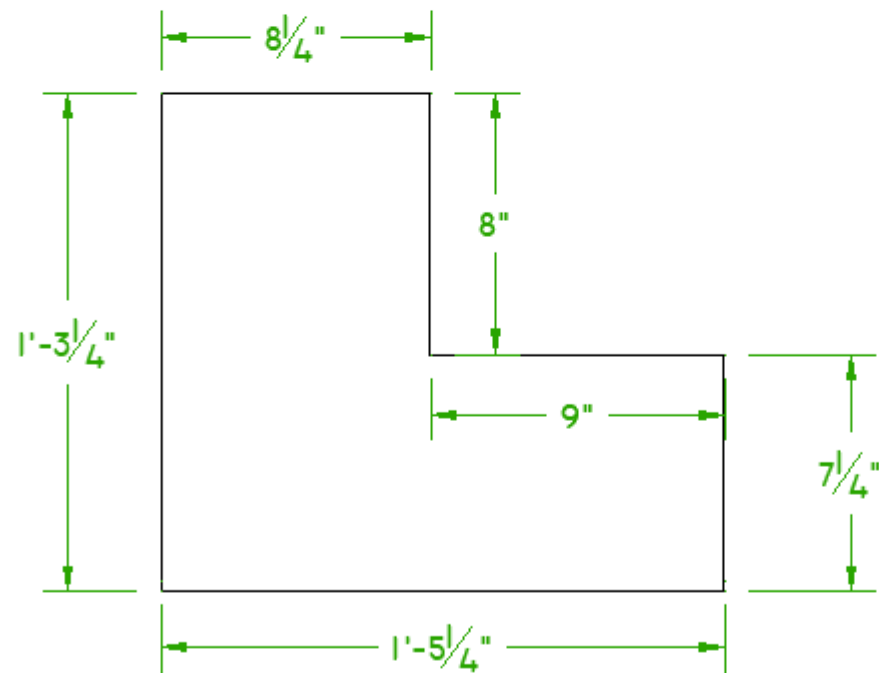

SL PLATFORM B STAIRS CARRIAGE

SIDE

- CUT FOUR TOTAL, CUT ONE THEN TRACE FOR NEXT THREE TO ENSURE THEY ARE IDENTICAL
- CUT FROM PLYWOOD

2"=1'

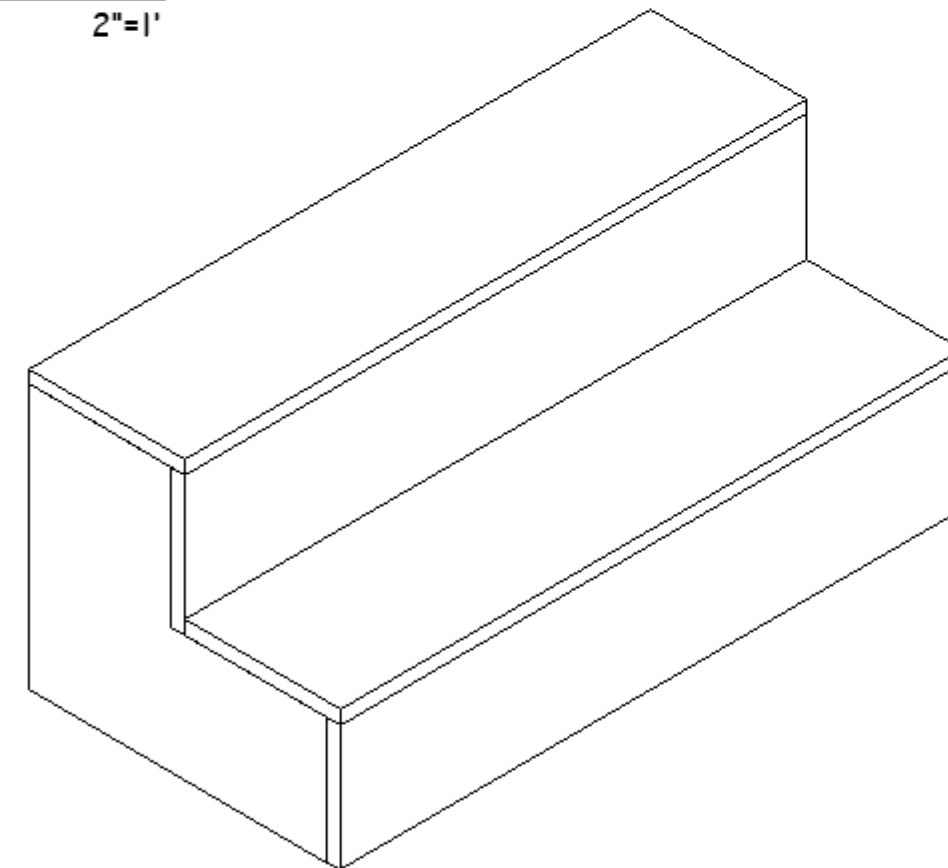

SL PLATFORM B STAIRS COMPOSITE

FRONT ISO

1-1/2"=1'

SCALE: VARIES

DATE: 12.31.21

THE HEIDI CHRONICLES

SL PLAT. B STAIRS

PRODUCED BY: OTTERBEIN UNIVERSITY

DIRECTOR: ELENI PAPALEONARDOS

DESIGNER: GABI AHUMADA MIER Y CONCHA

TECHNICAL DIRECTOR: SOPHIE RODRIGUEZ

PLATE #

8

OF: 32

THE HEIDI CHRONICLES USL WALL TWO

PRODUCED BY: OTTERBEIN UNIVERSITY

DIRECTOR: ELENI PAPALEONARDOS

DESIGNER: GABI AHUMADA MIER Y CONCHA

TECHNICAL DIRECTOR: SOPHIE RODRIGUEZ

PLATE #

21

OF: 34

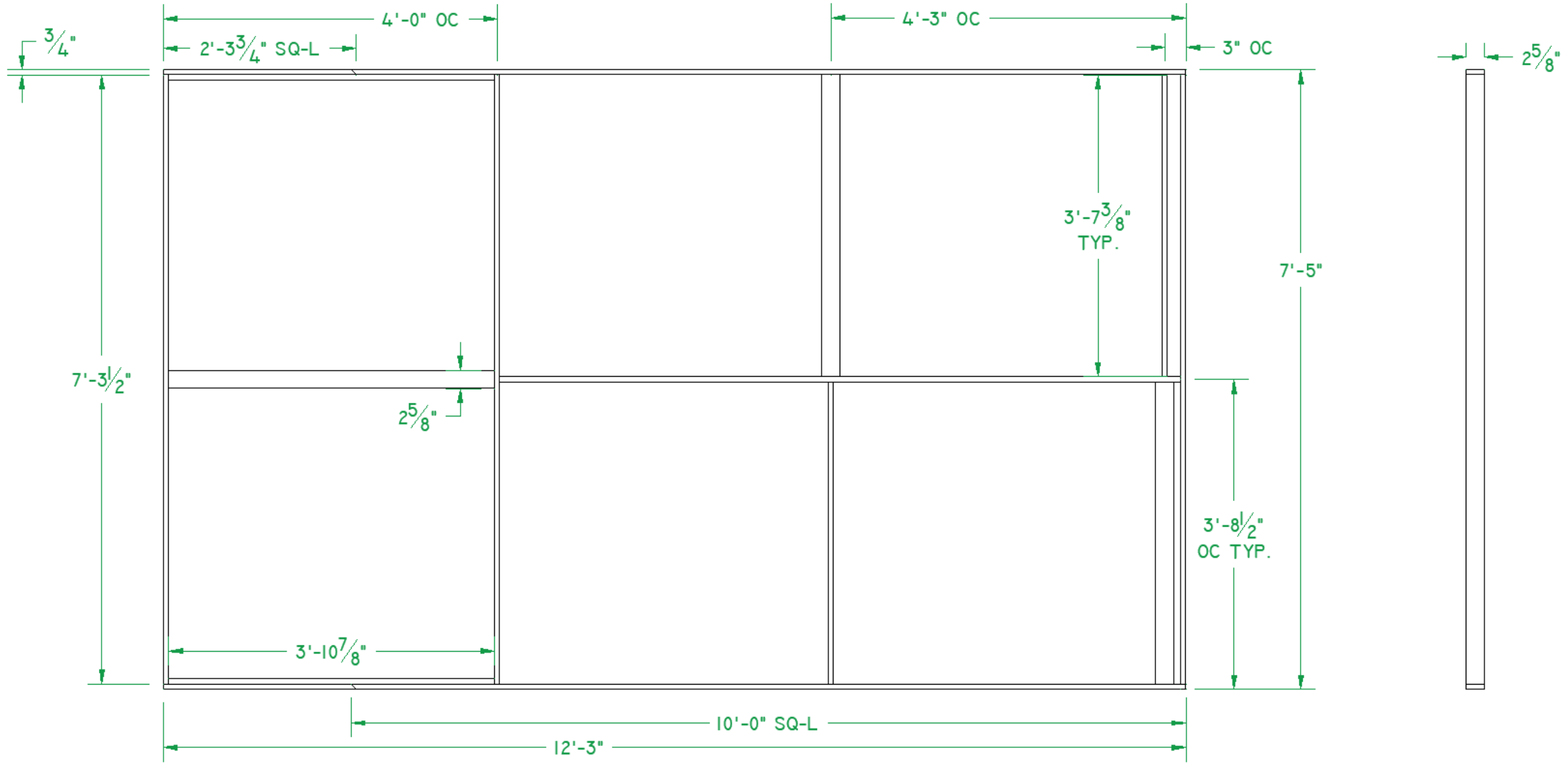

USL WALL TWO FRAME (ABOVE)

- BUILD WITH 1"X6" RIPPED TO 2-5/8"
- USE WOOD GLUE, SLANT NAILS, AND SCREWS
- NOTICE SCARF ON RAILS, CUT AT 45°
- ALTERNATE WOOD FOR ACCESSIBILITY WHEN CONSTRUCTING

TOP, SIDE

3/4"=1'

USL WALL TWO LAUAN LAYOUT (BELOW)

-- FACE WITH LAUAN, PATCH, AND LABEL WALL

TOP

1/4"=1'

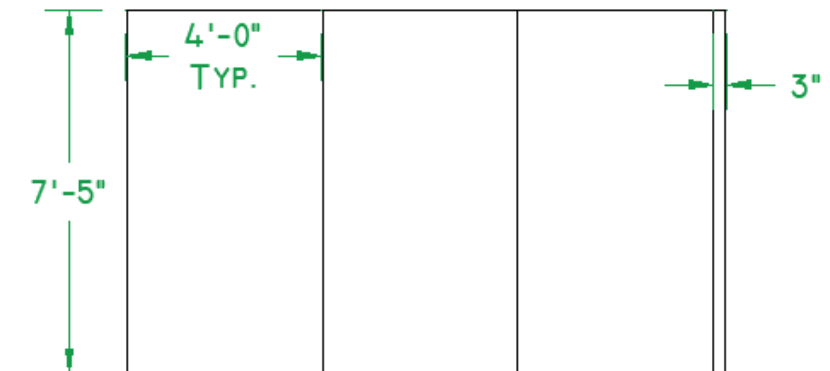

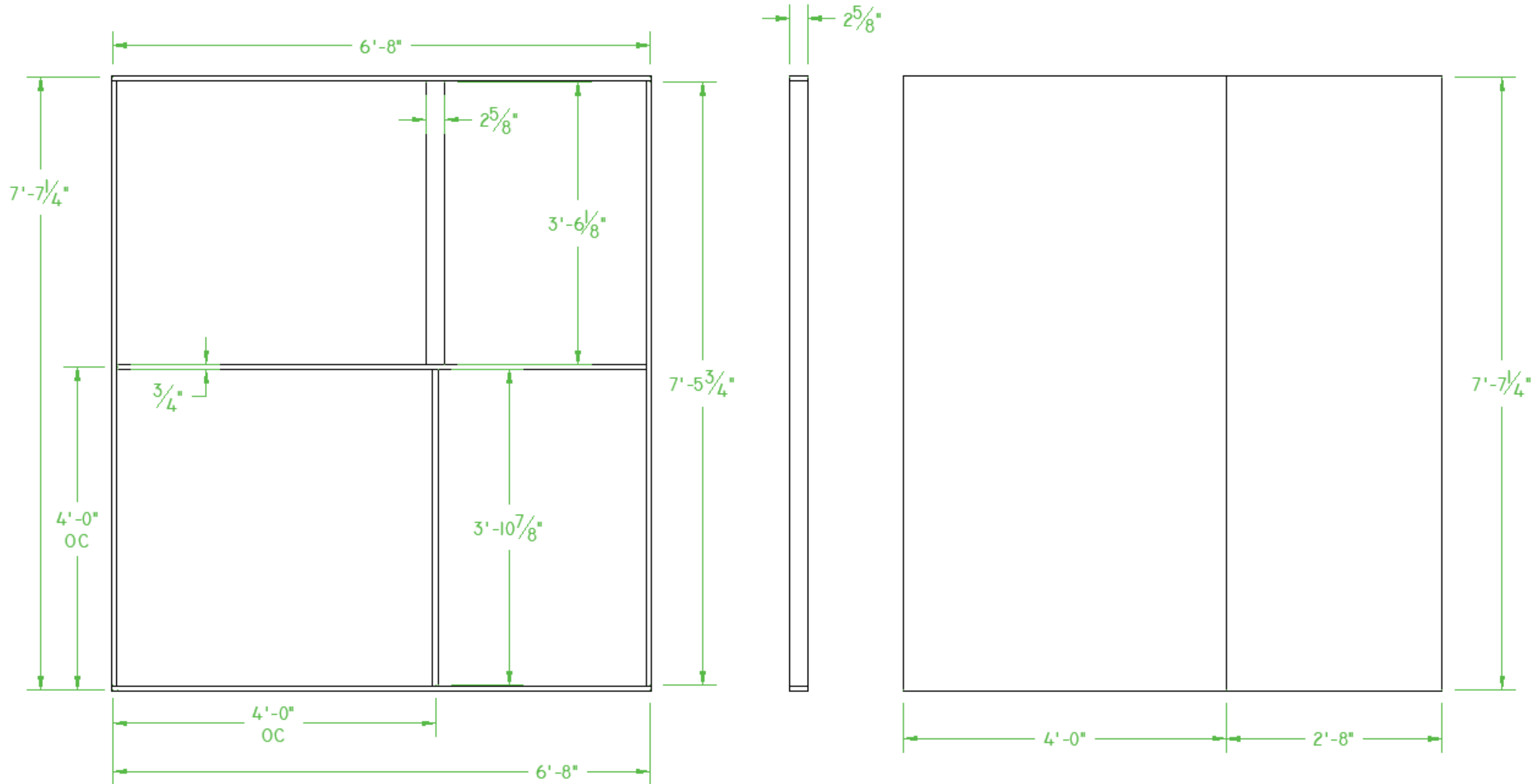

SCALE: 3/4"=1'

DATE: 11.30

THE HEIDI CHRONICLES

SR END WALL

PRODUCED BY: OTTERBEIN UNIVERSITY

DIRECTOR: ELENI PAPALEONARDOS

DESIGNER: GABI AHUMADA MIER Y CONCHA

TECHNICAL DIRECTOR: SOPHIE RODRIGUEZ

SR END WALL FRAME & COMPOSITE

TOP, SIDE

- BUILD WITH 1"x6" RIPPED TO 2-5/8"
- USE WOOD GLUE, SLANT NAILS, AND SCREWS
- ALTERNATE WOOD FOR ACCESSIBILITY WHEN CONSTRUCTING
- FACE WITH LAUAN, PATCH, AND LABEL WALL

3/4"=1'

PLATE #

22

OF: 34

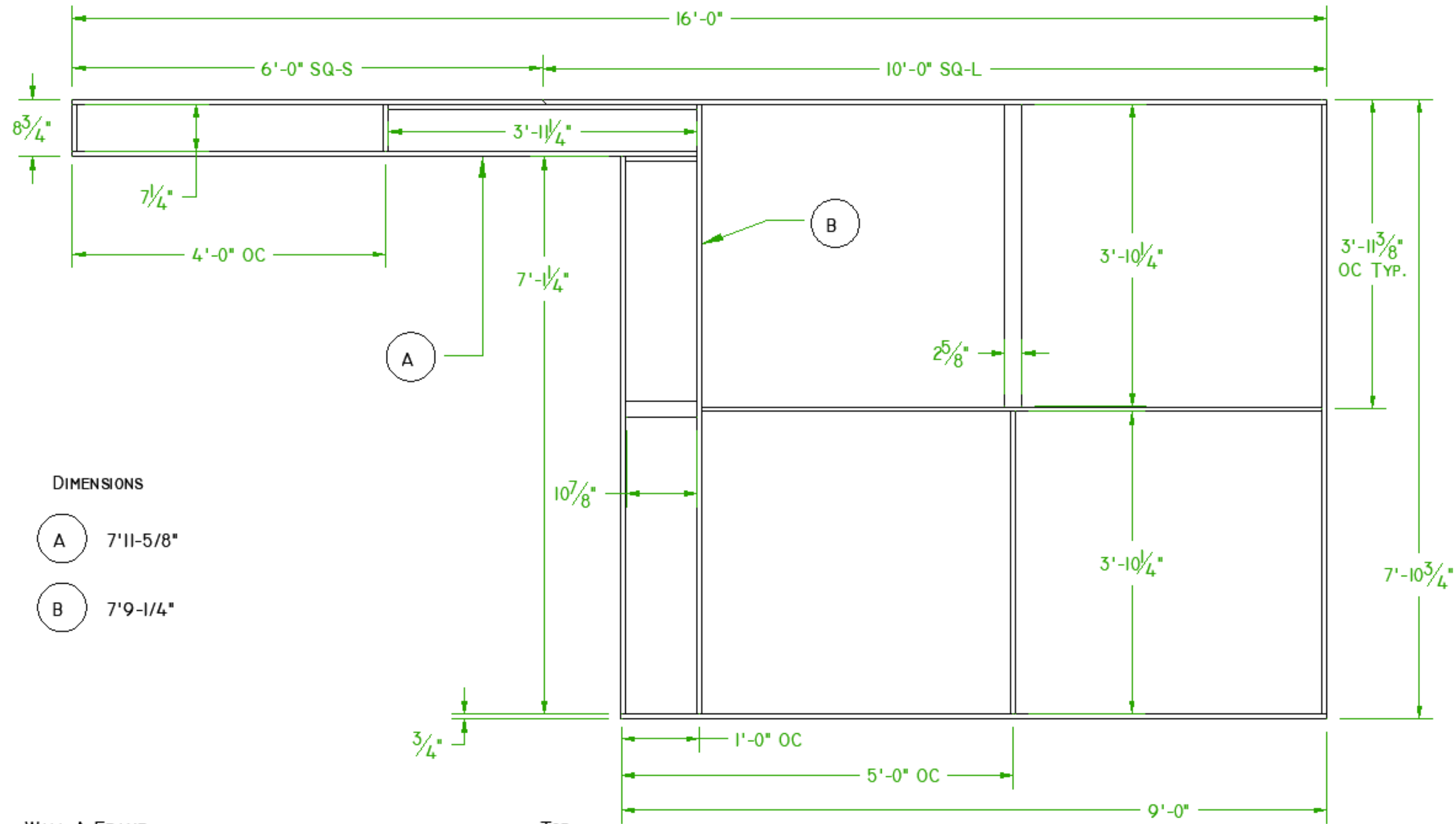

DIMENSIONS

- (A) 7'-11-5/8"
- (B) 7'-9-1/4"

WALL A FRAME TOP
 - BUILD WITH 1"x6" RIPPED TO 2-5/8" 3/4"=1'

- USE WOOD GLUE, SLANT NAILS, AND SCREWS
- ALTERNATE WOOD FOR ACCESSIBILITY WHEN CONSTRUCTING
- NOTICE SCARF ON TOP RAIL, CUT AT 45°
- FACE WITH LAUAN, PATCH, AND LABEL WALL, SEE PLATE NO.24 FOR LAUAN LAYOUT

THE HEIDI CHRONICLES
WALL A FRAME

PRODUCED BY: OTTERBEIN UNIVERSITY
 DIRECTOR: ELENI PAPAIONARDOS
 DESIGNER: GABI AHUMADA MIER Y CONCHA
 TECHNICAL DIRECTOR: SOPHIE RODRIGUEZ

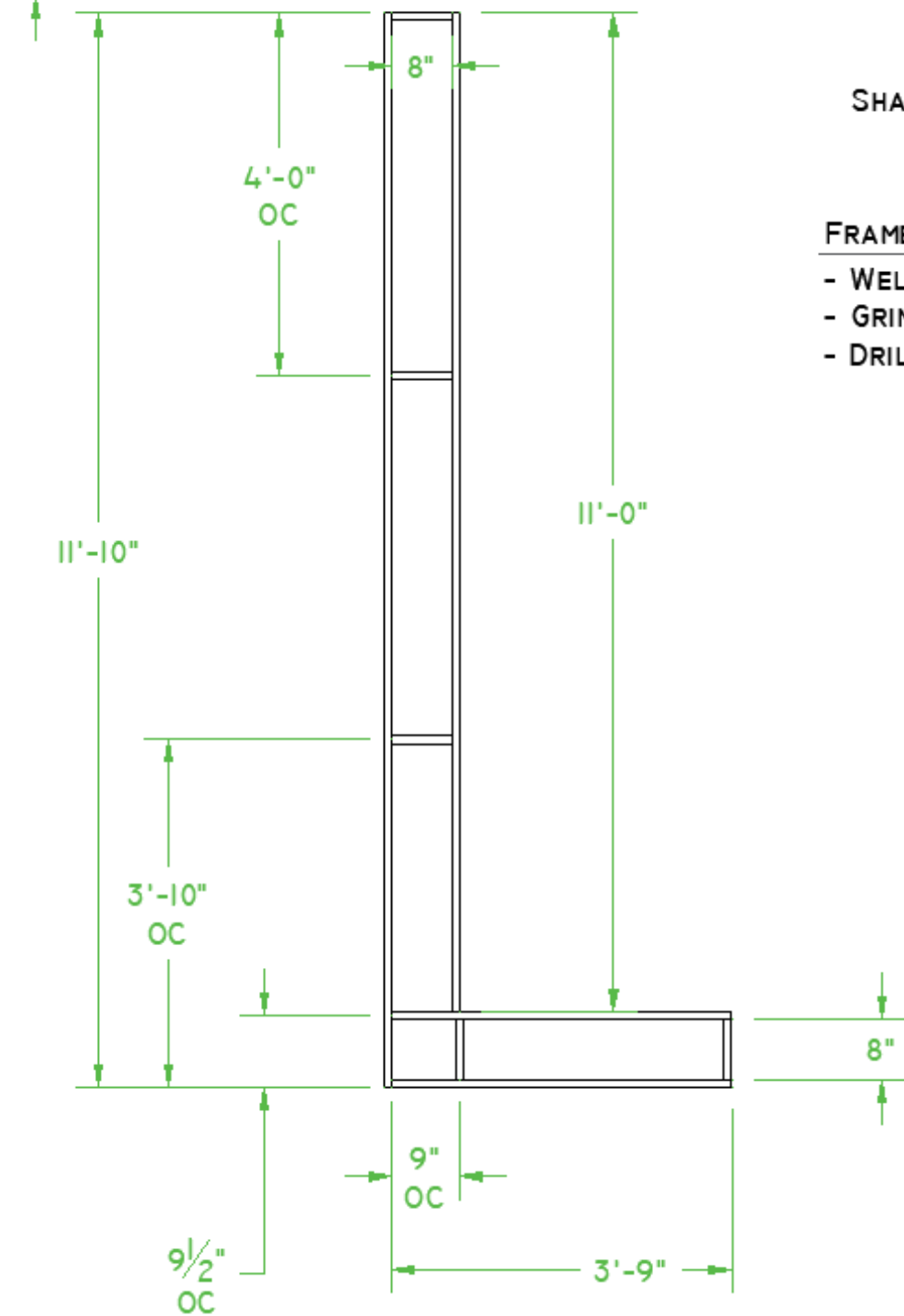
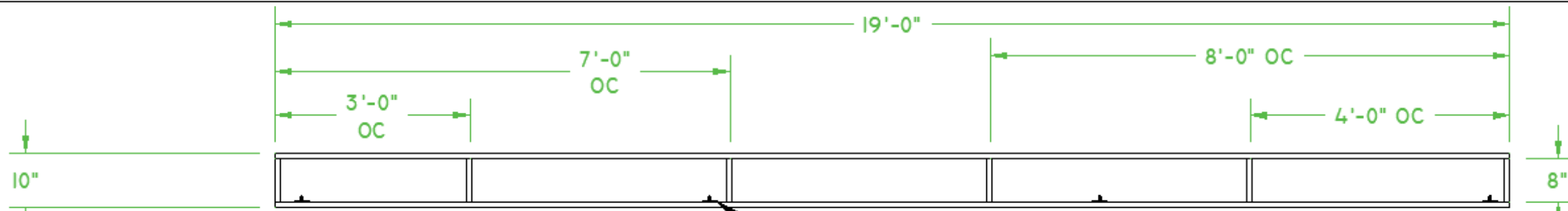

SHACKLE PLATE

FRAME C SR TOP
 - WELD WITH 1"X1" TUBE STEEL 1/2"=1'
 - GRIND BOTH SIDES
 - DRILL HOLES TO BOLT PIECES TOGETHER BEFORE FACING

FRAME C SR LAUAN TOP
 - SEE TD FOR RIGGING INSTRUCTIONS BEFORE FACING 1/4"=1'
 - USE LIQUID NAIL AND SCREWS TO ADHERE LAUAN

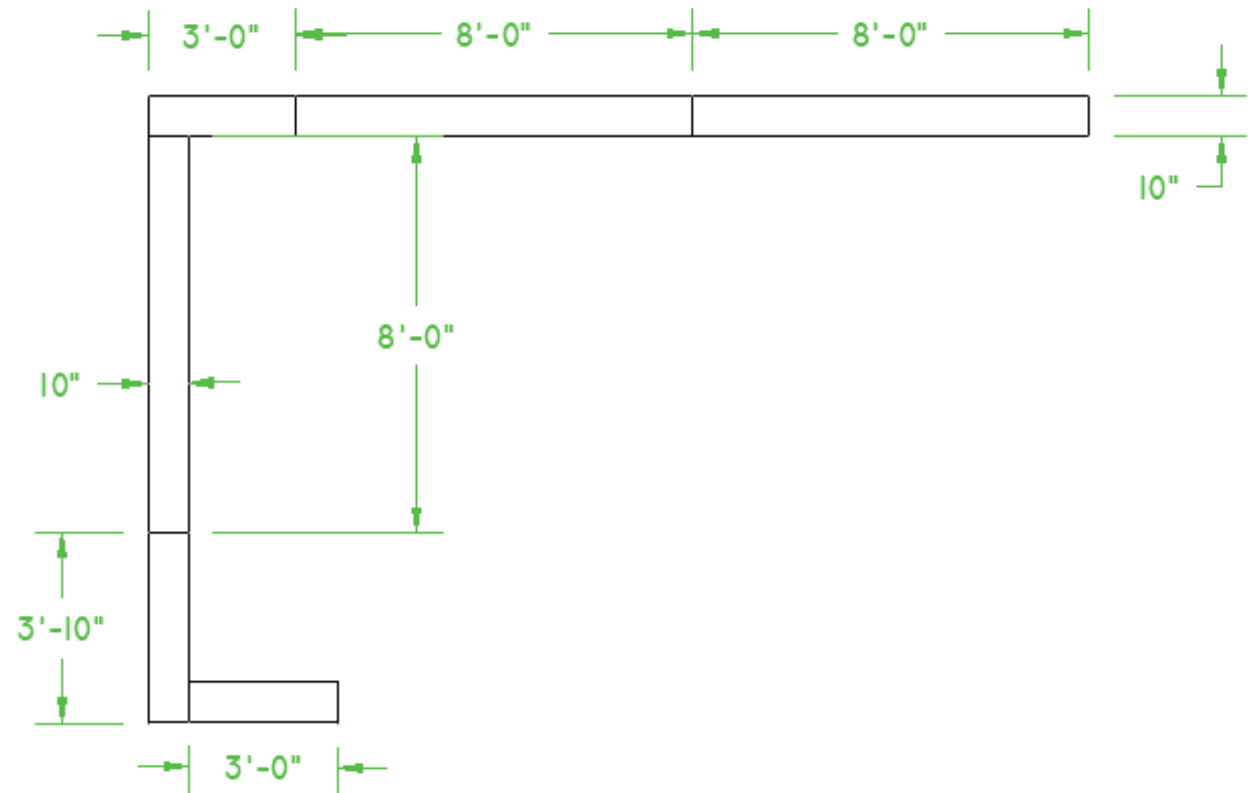

SCALE: VARIES

DATE: 1.1.30

THE HEIDI CHRONICLES

FRAME C SR

PRODUCED BY: OTTERBEIN UNIVERSITY
 DIRECTOR: ELENI PAPAIONARDOS
 DESIGNER: GABI AHUMADA MIER Y CONCHA
 TECHNICAL DIRECTOR: SOPHIE RODRIGUEZ

PLATE #
32
 OF: 34

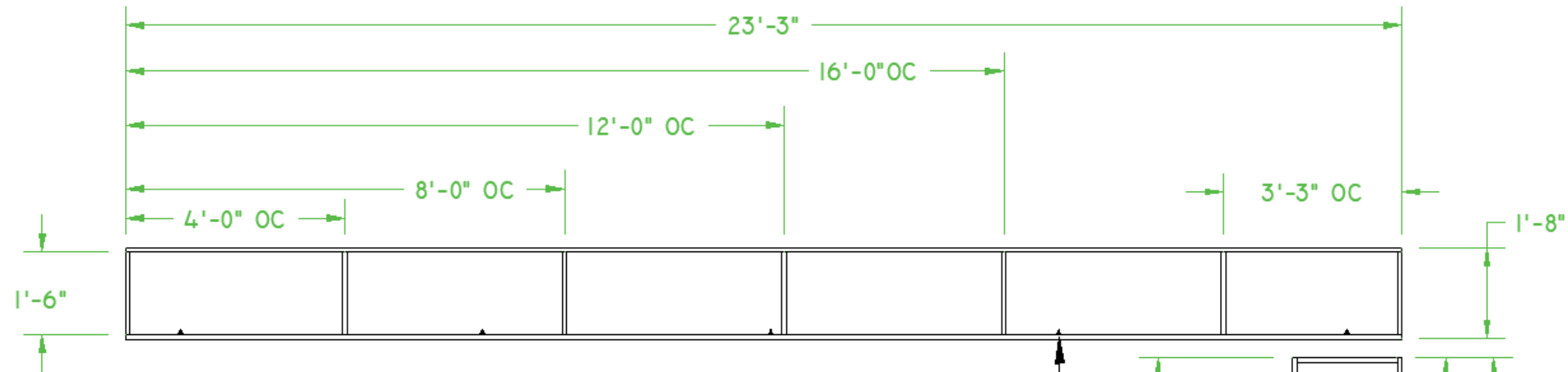

FRAME C SL **TOP**
 - WELD WITH 1"X1" TUBE STEEL 3/8"=1'
 - GRIND BOTH SIDES
 - DRILL HOLES TO BOLT PIECES TOGETHER BEFORE FACING

SHACKLE PLATE

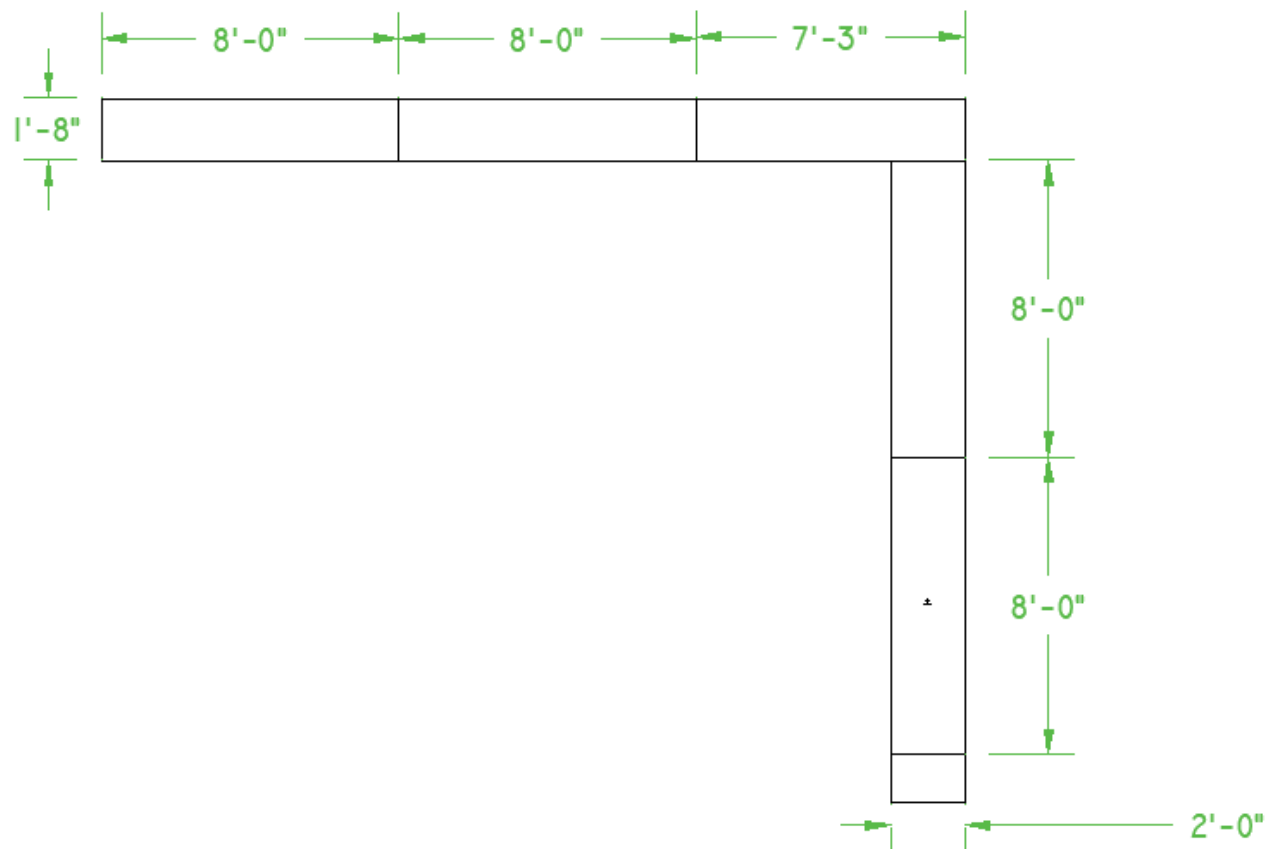

FRAME C SL LAUAN **TOP**
 - SEE TD FOR RIGGING INSTRUCTIONS BEFORE FACING 3/16"=1'
 - USE LIQUID NAIL AND SCREWS TO ADHERE LAUAN

SCALE: VARIES

DATE: 1.1.30

THE HEIDI CHRONICLES

FRAME C SL LAUAN

PRODUCED BY: OTTERBEIN UNIVERSITY

DIRECTOR: ELENI PAPAIONARDOS

DESIGNER: GABI AHUMADA MIER Y CONCHA

TECHNICAL DIRECTOR: SOPHIE RODRIGUEZ

PLATE #

33

OF: 34